

Assembly Layout/装配方案

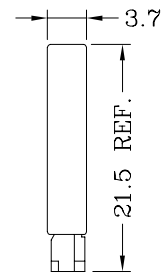

Wire to Wire/线对线

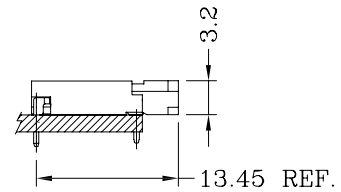

Wire to Board/线对板(DIP)

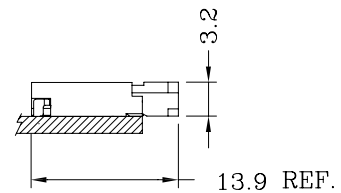

Wire to Board/线对板(SMT)

Specifications/技术参数:

Poles/位数	2 Poles
Pitch between poles/间距	3.50mm
Rated Voltage/额定电压	1400V AV,DC
Rated Current/额定电流	1A (AWG #24)
Withstand Voltage/耐压值	3800V AC/minute
Contact Resistance/接触电阻	10mΩ (MAX.)
Insulation Resistance/绝缘电阻	1000MΩ (MIN.)
Temperature Range/温度范围	-25°C ~ +85°C
Applicable Wire Range/适用线径	AWG #24~#28

ABHD1 SERIES 3.50mm Pitch Crimp Terminal Socket

Features/产品特性:

- * Material(材质): Nylon 66 UL 94V-0 (White)
- * Suitable for ABHD1 series terminal (适用于ABHD系列端子)
- * Mates with ABHD2 socket (与ABHD2塑壳配合)

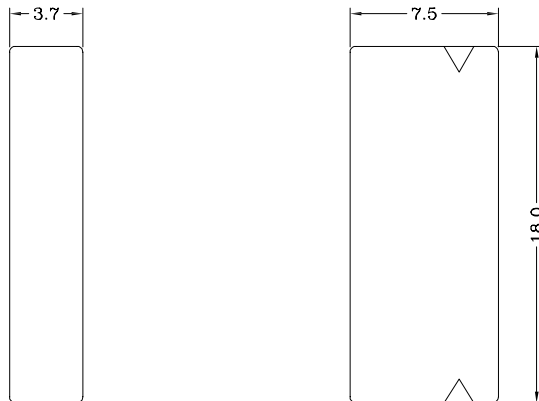

ABHD1-H-02P

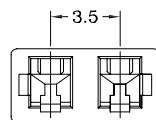

ABHD1 SERIES 3.50mm Pitch Crimp Terminal

Features/产品特性:

- * Used in ABHD1 socket (用于ABHD2塑壳)

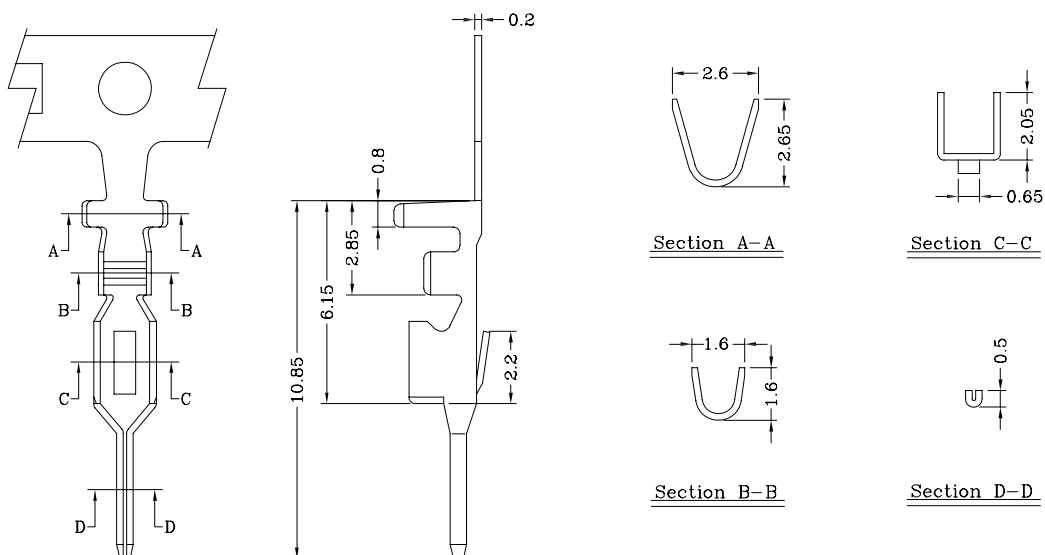

Part No./产品型号	Wire Range/线径范围	Insulation O.D/线外径	Material/材质	Finish/表面处理
ABHD1-T-P	AWG #24 ~ #28	1.70mm(max)	Phosphor bronze	Tin-plated

ABHD2 SERIES 3.50mm Pitch Crimp Terminal Socket

Features/产品特性:

- * Material(材质): Nylon 66 UL 94V-0 (White)
- * Suitable for ABHD2 series terminal (适用于ABHD2系列端子)
- * Mates with ABHD1 socket & ABHD wafer (与ABHD1塑壳或ABD插座配合)

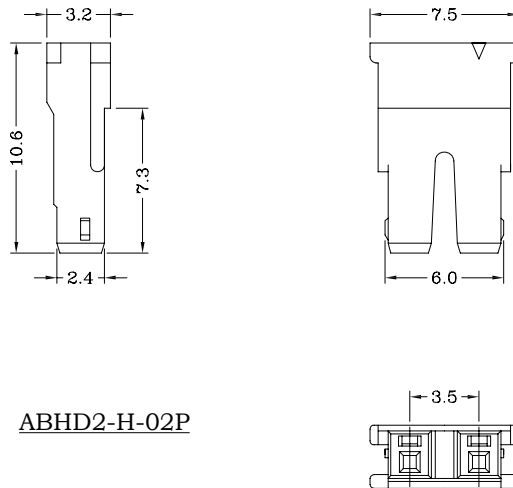

ABHD2-H-02P

ABHD2 SERIES 3.50mm Pitch Crimp Terminal

Features/产品特性:

- * Used in ABHD2 socket (用于ABHD2塑壳)

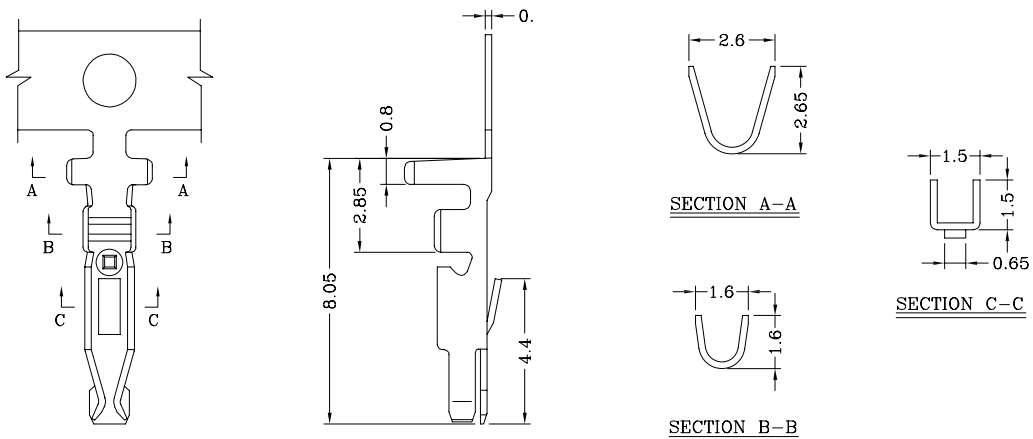

Part No./产品型号	Wire Range/线径范围	Insulation O.D/线外径	Material/材质	Finish/表面处理
ABHD2-T-P	AWG #24 ~ #28	1.70mm(max)	Phosphor bronze	Tin-plated

ABHD SERIES 3.50mm Pitch Crimp Wafer (DIP-Type)

Features/产品特性:

- * Material(材质):
 Insulator(塑胶本体): Nylon 6T UL 94V-0
 Contacts(接触件): Brass, Tin-plated
 Solder Tab(焊盘片): Brass, Tin-plated
- * Mates with ABHD2 socket (与ABHD2塑壳配合)

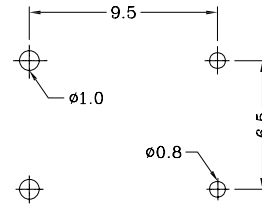
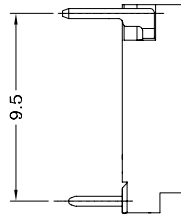
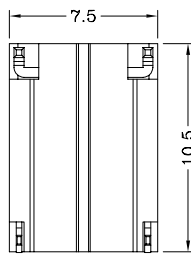
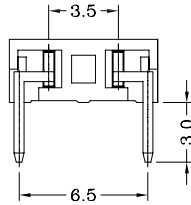

P.C.B. LAYOUT
线路板布局图

ABHD-H-02P

ABHD SERIES 3.50mm Pitch Crimp Wafer (SMT-Type)

Features/产品特性:

- * Material(材质):
 Insulator(塑胶本体): Nylon 6T UL 94V-0
 Contacts(接触件): Brass, Tin-plated
 Solder Tab(焊盘片): Brass, Tin-plated
- * Mates with ABHD2 socket (与ABHD2塑壳配合)

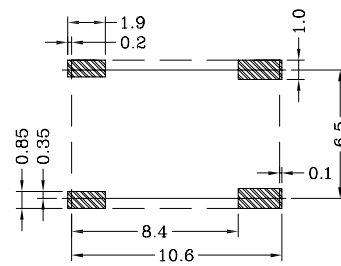
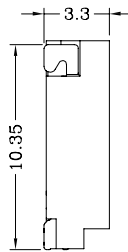
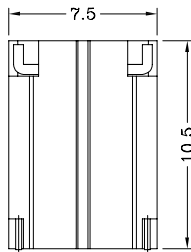
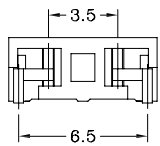

P.C.B. LAYOUT
线路板布局图

ABHD-SMR-02P